

Pipetting 101

Pipette key parts

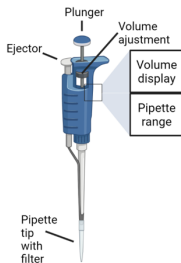

How to set and read pipette volume

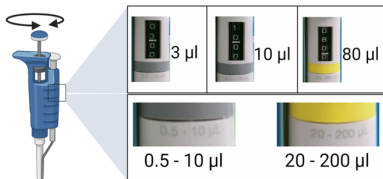

Turn volume adjustment to change pipetting volume

NEVER GO ABOVE OR BELOW PIPETTE RANGE
IF YOU FEEL RESISTANCE, DO NOT FORCE THE TURN

How to take up and eject tips?!

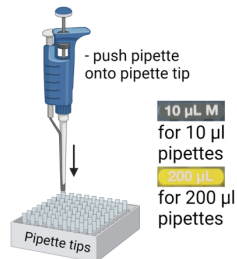

Select appropriate tip for pipette range, indicated on pipette tip box



How to pipette volumes

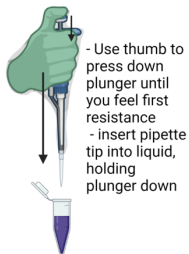

Tube A

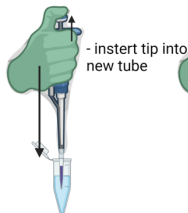
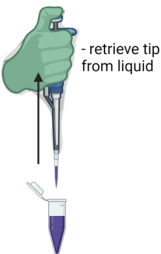
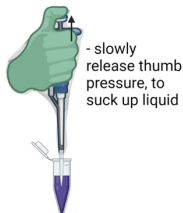

Tube B

